



jcmtechnologies
quick guide

GO-PRO2 IND/GO-PRO4 IND

Intensive destiny transmitter

Technical Data

868 MHz · 2 x 1,5Vdc AAAA LR61 / 12mA
Radiated power < 1mW · Temp. -20°C - + 55°C

EN

Programming

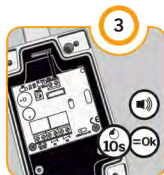

Maintenance

PROG



BATTERY REPLACEMENT

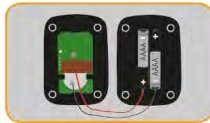

Operation

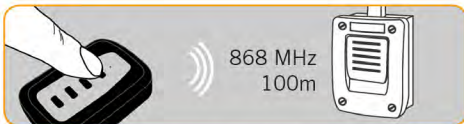

The manufacturer ESA08827974 declares that the product S-GO2-RFPIC-DO and S-GO4-RFPIC-DO comply with the relevant fundamental requirements as per Article 3 of the R&TTE Directive 1999/05/EC. In case of battery replacement or before throwing away the device, the batteries must be removed and deposited in a collection point.

EC Decl.: www.jcm-tech.com/declarations/

