

Opyn Pedestal Mount Guide

Gather materials & ensure you have the following materials and tools:

- Opyn Telephone entry unit & backbox hood.
- 4x Mounting screws, 1x security screw, Screwdriver and allen key.
- Sealing gun & silicone sealant.

1. Align the Backbox Hood

Position the backbox hood over the pedestal. Line up the four screw holes in the hood with the corresponding holes on the pedestal.

2. Insert the Screws

Place the screws through the four holes in the backbox hood, ensuring they align securely with the pedestal's pre-drilled holes.

3. Attach the Hood to the Pedestal*

Using a screwdriver or power drill, tighten the screws evenly into the pedestal. Avoid over-tightening to prevent damage to the hood or pedestal.

4. Secure and Test Stability

Double-check that all screws are tight and the backbox hood is firmly attached. The hood should not wobble or shift.

5. Seal Unit

Seal all unused holes by using a sealant such as silicone.

6. Opyn Unit

Insert the Opyn Telephone Entry Unit into the backbox hood and secure the unit with the security screw entering from the bottom.

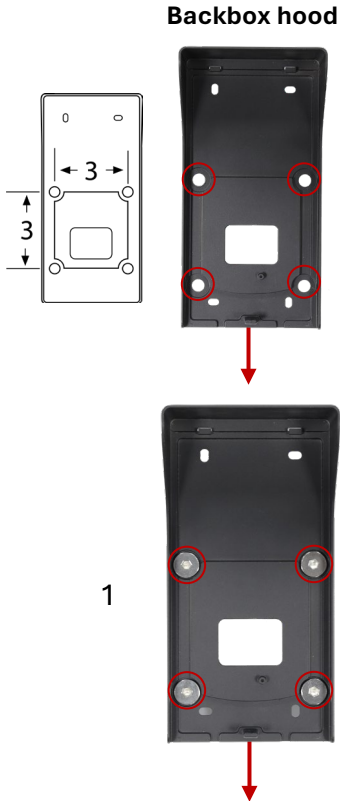

Pedestal mount plate

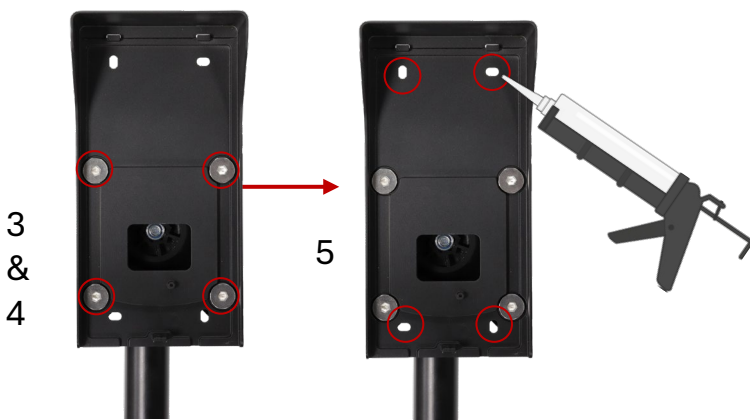

*Pedestals look my vary.