

Programming

Radio Manual Programming (Remote controls, wireless buttons, etc)

OPEN TOP

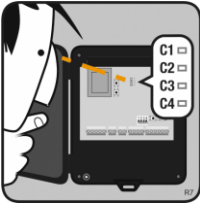

PRESS RED RPROG PUSHBUTTON



LED TURNS ON

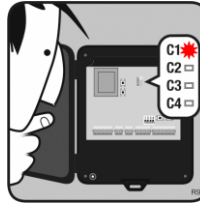

PRESS TRANSMITTER



PRESS RED PROG PUSHBUTTON



LED TURNS OFF

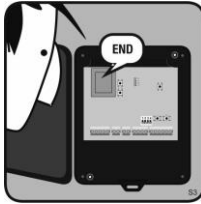

NOTE: To program transmitters onto different channels, press and hold the red RADIO PROG pushbutton until the LED for that channel turns on, then release the RADIO PROG pushbutton and press the transmitter.

Total Reset

OPEN TOP

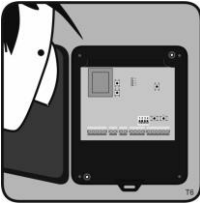

PRESS & HOLD RED RPROG PUSHBUTTON



BRIDGE MR



SEVERAL BEEPS



END RESET



PRESS RED RPROG PUSHBUTTON

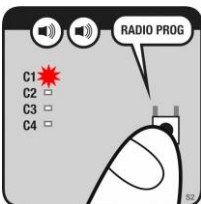

LED TRUNS OFF

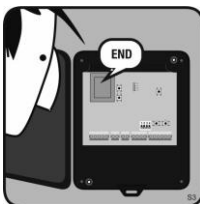

Safety devices programming

RadioBand3 Transmitter Programming in RSEC3 Receiver

Wire in the safety edge and set the dipswitches according to the RB3 TGL868 manual before programming.

PRESS PROG BUTTON OF THE PLUGABLE CARD RSEC3



LED TURNS ON

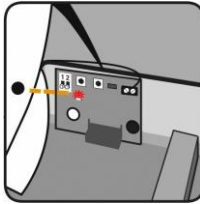

PRESS PROG TRANSMITTER

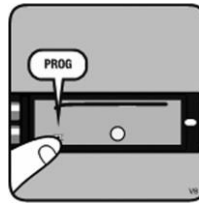

ONE BEEP AND PROGRAMMED



PRESS PROG BUTTON



LED TURNS OFF AND END PROG

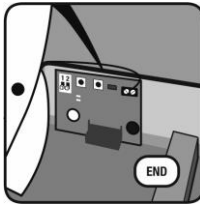

SLIDE THE COVER TO CLOSE

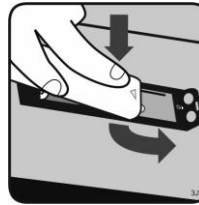

Maneuver programming

Programming the door maneuver

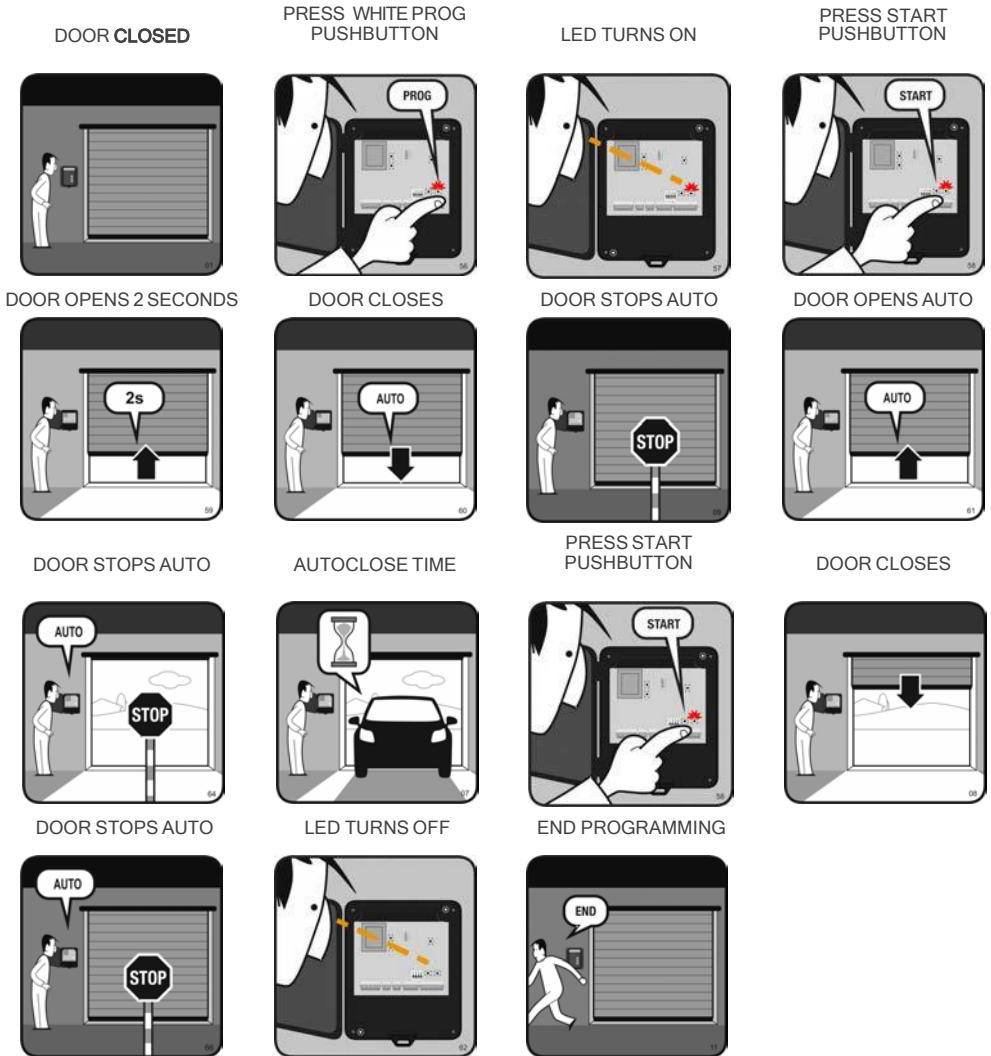

Inputs, outputs, dip-switches & radio inputs

Factory default settings. All the below can be modified with the VERSUS-PROG programming tool. If they are modified, please ensure this manual and the sticker on the inside of the control panel cover is updated.

For a full list of the settings & parameters available and their definitions, please refer to the VERSUS manual.

OUTPUTS		
OUT1	FLASH	
OUT2	COURTESY LIGHT LEVEL	
OUT19	AUTOTEST SIGNAL	
DIPSWITCH OPTIONS		
SW1	AUTOCLOSE	
SW2	DEADMAN	
SW3	PRE-FLASH	
SW4	SEC. CLOSE TEST	
INPUTS		
IN1	SEC. CLOSE AUTOTEST (NC)	
IN2	START (NO)	
IN3	STOP (NC)	
RADIO INPUTS		
IN31 (C1)	START RADIO SEC_DM	
IN32 (C2)	DEAD MAN CLOSE	
IN33 (C3)	OPEN	
IN34 (C4)	CLOSE	

Regulatory Data

EU Declaration of conformity

JCM Technologies hereby declares that the product **M8NF** complies with the relevant fundamental requirements of the RED Directive 2014/53/EU, as well as with the Machine Directive 2006/42/EC whenever its usage is foreseen; and with the 2011/65/EU RoHS Directive.

See website www.jcm-tech.com/declarations/

JCM TECHNOLOGIES, SA
C/COSTA D'EN PARATGE, 6B
08500 VIC (BARCELONA)
SPAIN

